

Two (2) NEEDLE WALKING FEET with Compensating Center Guide

for Pfaff 145, 335, 545, 1245 for Highlead GC2698, GC2698-1BN for Typical P335, P355WB, TW3, TW1-1245

These sets of double needle feet with spring loaded center guide facilitate straight sewing along a center seam with equal distance stitching on both sides of the seam. The adjustable spring loaded center guide is always in contact with the material even when the walking feet go up. The stitching will always be even.

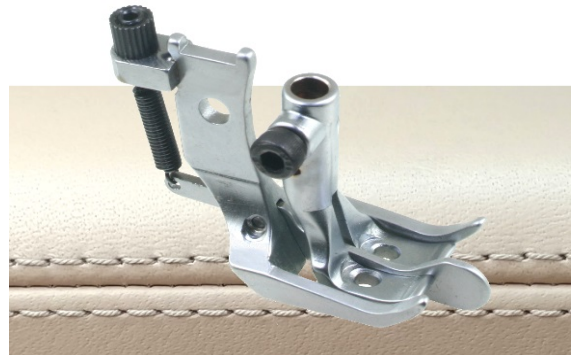

Sets of Outside & Inside Feet

#PFTP-1/4 1/4" (6 mm)
#PFTP-3/16 3/16" (5 mm)

#PFTP-5/16 5/16" (8 mm)
#PFTP-3/8 3/8" (9.5 mm)

EDGE GUIDE FEET 1-Needle Left Hand Guide

Facilitates straight sewing edge - Adjustable compensating Guide maintains contact with material



Sets of Outside & Inside Feet

GL1245-3 1/8"
GL1245-4 5/32"
GL1245-5 3/16"
GL1245-6 1/4"
GL1245-8 5/16"

EDGE GUIDE FEET 1-Needle Right Hand Guide

Sets of Outside & Inside Feet

GR1245-3 1/8"
GR1245-4 5/32"
GR1245-5 3/16"
GR1245-6 1/4"
GR1245-8 5/16"



Piping Feet for Pfaff 145, 1245 etc



Sets of Outside & Inside Feet

42519x20 1/8"
42519x20 5/32"
42519x20 3/16"
42519x20 1/4"
42519x20 5/16"
42519x20 3/8"

Piping Feet with Teeth for Pfaff 145, 1245, etc



Sets of Outside & Inside Feet

42519Tx20 1/8"
42519x20T 5/32"
42519x20T 3/16"
42519x20T 1/4"
42519x20T 5/16"
42519x20T 3/8"

Double Piping Feet for Pfaff 145, 1245 etc



Sets of Outside & Inside Feet

42180/1 3/16"
42180/1 1/4"

Single Toe Piping Feet



91-042442-93x3.5 1/8" Inside Foot
91-042442-93x5.0 3/16" Inside Foot
91-042442-93x6.5 1/4" Inside Foot
91-042443-93x3.5 1/8" Outside Foot
91-042443-93x5.08 3/16" Outside Foot
91-042443-93x6.5 1/4" Outside Foot

Set Inside & Outside:

42442/3 1/8 SET
42442/3 3/16 SET
42442/3 1/4 SET